

CITY OF NOWTHEN

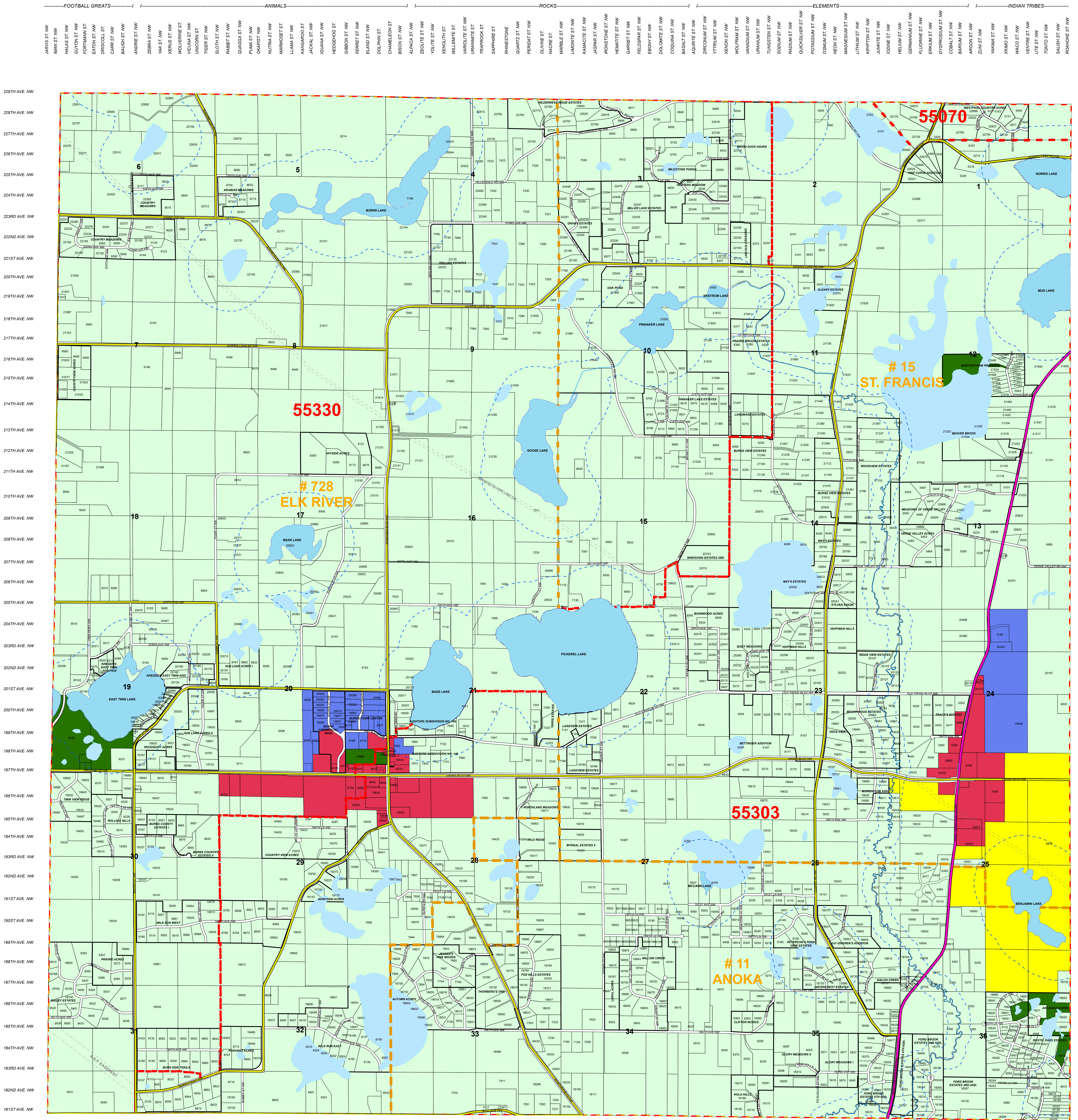

<p>ZONING</p> <ul style="list-style-type: none"> C-1 - Commercial District (365 acres / 1.72%) I-1 - Industrial District (255 acres / 1.06%) CON - Conservancy District (156 acres / 0.74%) RRA - Rural Residential Agriculture (19,897 acres / 94.20%) RRT - Rural Residential Transition (478 / 2.26%) Shoreland Overlay District 	<p>LEGEND</p> <ul style="list-style-type: none"> Zip Codes Elementary School Districts Plat Areas City Boundary Lake Pond Stream 	<div style="text-align: center;"> <p>N</p> </div> <p style="text-align: right;">REVISED: NOVEMBER 2023</p> <div style="text-align: right;"> <p>Hakanson Anderson</p> </div>
--	---	--

SOURCES: ANOKA COUNTY GIS DEPT, CITY OF NOWTHEN & METROPOLITAN COUNCIL GIS DEPT